

Baby.i Owl Camera

User Manual

Getting Started

Included:

Owl Camera x 1

Power cable x 1

User guide

Mounting accessory x 1

Product:



Installation

- 1/ Confirmed the wifi network is turned on and connection is fine.
- 2/ Smartphone is also connecting the same wifi network.
- 3/ Scan below QR code to download and install Baby.i Owl Camera app
OR download “Danale” in Play Store & Apple Store.



- 4/ Once, user follows the instruction to complete the registration.
- 5/ Connected with the power cable and adaptor to turn on the Baby.i Owl Camera.
- 6/ Press “+” button to connect new device.
(Refer to fig. 1)
- 7/ Enter the wifi network login and password.
- 8/ App starts to search the camera.
- 9/ Use the pin to press and hold the reset button until the reset successful and red light flash.
- 10/ App will search the camera within 100s. If its successful, device will appear on app.

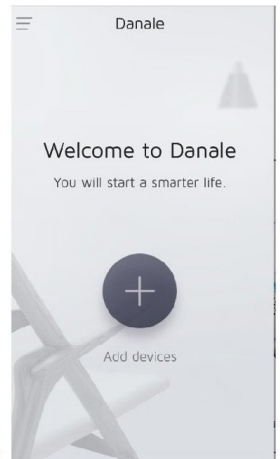

fig.1

11/ Add the device by app to pair the wifi network. Refer to fig.2 & 3.

fig.2

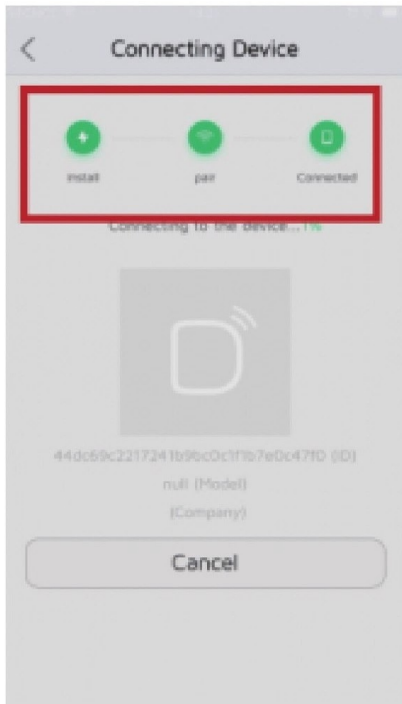
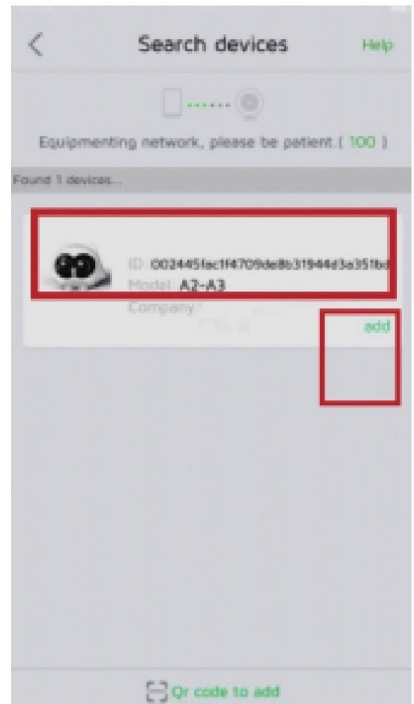

fig.3



12/ After the pairing successful, user can rename the device.

13/ Then, user can see "Add Device Success" on screen.

App Operaton

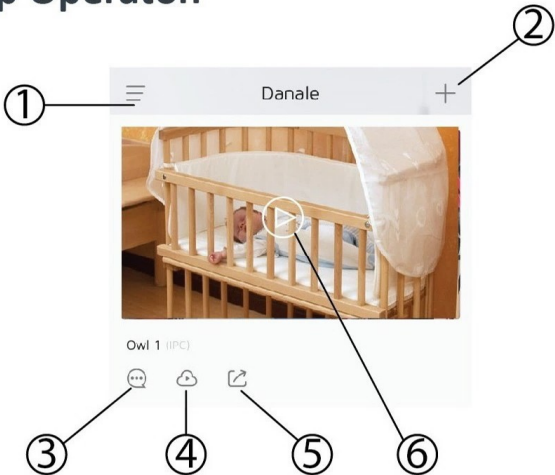

1/ Setting

2/ Add new device

3/ Alert notification

4/ Cloud service

5/ Scan QR code

6/ Play live

Live screen



Select camera

Setting

Video recording

Talk

Take photo

Real time sound on/off

Show 1/4 view

Mounting Accessory

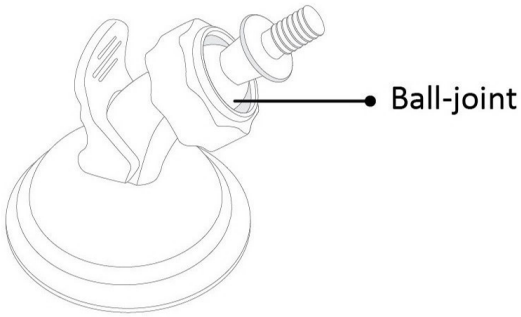

- 1/ Screw in to join the camera
- 2/ Place on any smooth surface (ensure the surface is clean)
- 3/ Pull down the lock to fix on the surface
- 4/ Adjust the camera viewing angle by ball-joint

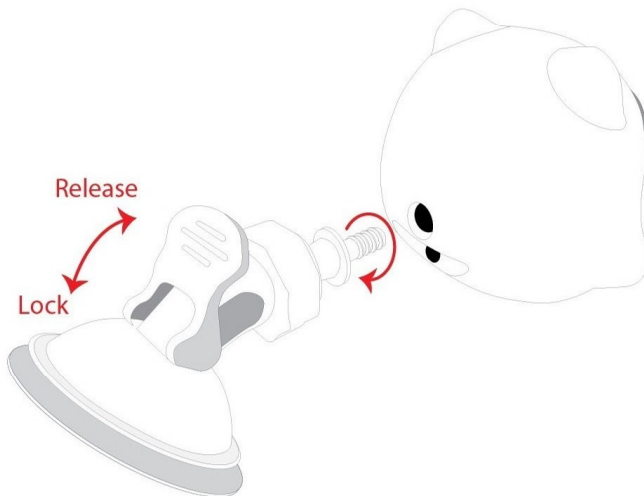

Maintenance

CAUTION! To avoid electric shock and damage to your device, do not charge device while it is wet or in an area where it could get wet. Do not handle device, charger or cords with wet hands while charging. Whenever your device gets wet, dry it thoroughly with a clean, soft cloth. If your device has gotten wet, you should dry the inside of the charging port before inserting a power connector to charge your device. If the charging port is not fully dry, your device may operate abnormally. For example, it may charge more slowly or overheat.

Restricting Children’s Access to Your Device

Your device is not a toy. Do not allow children to play with it because they could hurt themselves and others, damage the device. Keep the device and all its parts and accessories out of the reach of small children.